

AlwaysFresh®
Water the way you want it®

HFC-1000

High Flow (1.5 gpm)

Drinking Water System

AlwaysFresh®

Water the way you want it®

5 Stage Exclusive Patented Quick Change Design

Filter Protection Silver Zeolite Technology

Lime Scale Protection*

Built-in Pre filter 5.0 micron

Fine Filtration 0.5 micron

>1,000,000 square meters of adsorptive chemical sites

* claim not verified by IAPMO R&T



Rated for 500 gallons

Flush cartridge for 5 gallons each time cartridge is installed

"This system was evaluated to a test capacity of 1000 gallons,

200% of the rated capacity of 500 gallons!"

Replace cartridge after 500 gallons for optimum chemical

reduction, when flow becomes inconveniently slow or at least once a year.

NOTE: This drinking water system must be maintained according to the manufacturer's instructions, including replacement of filter cartridge. "The end-user should not attempt to regenerate and reuse spent media from this product"

Waterline Technology®
1904 Industrial Way
Caldwell, ID 83605
www.waterlinetechnology.com

1-800-522-3949

Reorder # RC-HFC-1000

Date Installed _____

Installing Cartridge

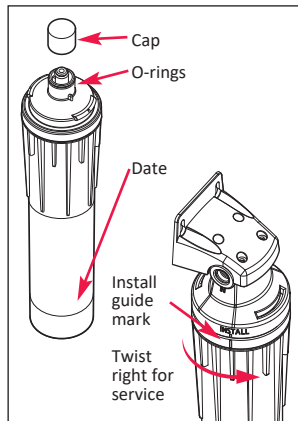

- 1) Write installation date on new filter label.
- 2) Remove and discard cap.
- 3) Inspect O-rings for any damage.
- 4) Make sure both O-rings are present and positioned correctly in the grooves.
- 5) Moisten O-rings with water or lubricant
- 6) Align cartridge guides to install position.
- 7) Push upward to seat O-rings into filter head.
- 8) Turn cartridge to right and align with service marks.
- 9) Open activation valve for at least two minutes to remove any air in the system.
- 10) Check for leaks.

Removing Cartridge

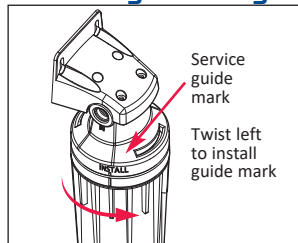

- 1) Turn off water supply to cartridge
- 2) Open activation valve to relieve pressure and insure water supply is off.
- 3) Turn cartridge to left until aligned with install mark.
- 4) Pull cartridge down to remove it. A small amount of water may be discharged.
- 5) Cartridge housing is recyclable!

HFC-1000

High Flow (1.5 gpm)

When this cartridge is inserted into one of the Alwaysfresh® Filter head models (HFH38-NPT, HFC38-QC, HFHV38-QC)

This system is certified WQA & IAPMO RT to CSA B483.1, NSF/ANSI 42, 53, 401* NSF/ANSI/CAN372 For specific performance claims as verified and substantiated by test data

Standard 42: Aesthetic Effects

Chemical Unit

Taste and Odor Reduction
Aesthetic Chlorine Reduction

Mechanical Filtration Unit

Particulate Reduction Class 1: 0.5 micron and larger in size

Standard 53: Health Effects

Chemical Reduction Unit

MTBE Reduction
VOC Reduction
TTHM's
Lead Reduction
Perfluorooctanoic acid (PFOA) & Perfluorooctane sulfonic acid (PFOS)

Mechanical Filtration Unit

Turbidity Reduction
Cyst Reduction

NSF/ANSI/CAN 372

Low Lead Content <.25% of wetted parts

NSF/ANSI 401*

Qualifies as result of Turbidity Reduction under NSF STD 42

Operating Specifications

Min/Max working pressure: 30 psi (2.1 bar)/125 psi (8.6 bar), nonshock

Temperature: 35-100° F (2-38° C)

Service flow rate 1.5 gpm (5.7 Lpm)

Rated Service Capacity: 500 gallons (1890 L)

For conditions of use, health claims and replacement parts see performance data sheet. California Waterboards Certification Number 3330.

Product performance is dependent upon incoming water conditions. Do not use with water that is microbiologically unsafe or of unknown quality without adequate disinfection before or after the system. systems certified for cyst reduction may be disinfected on waters that may contain filterable cysts. Conforms to NSF/ANSI 53 for VOC reductions. See performance data sheet for individual contaminants and reduction

The contaminants or other substances removed or reduced by this water filter device are not necessarily in your water.

©Waterline Technology® Protected under patents 6,695,891, 6,926,826, 6,977,006, 7,172,693, 7,476,314 and other Patents Pending

Manufactured at EPA Establishment Number 070932-ID-001

